

BB-43.

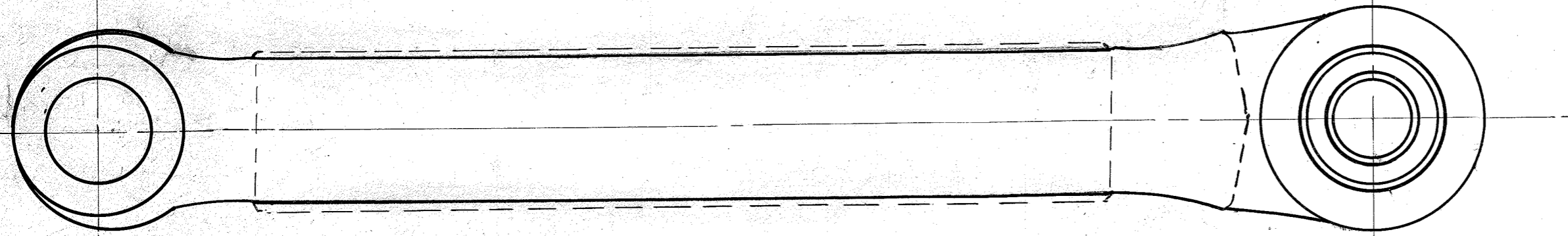

$10 \frac{3}{32}$

BB-41

BB-42

$\frac{1}{8}$

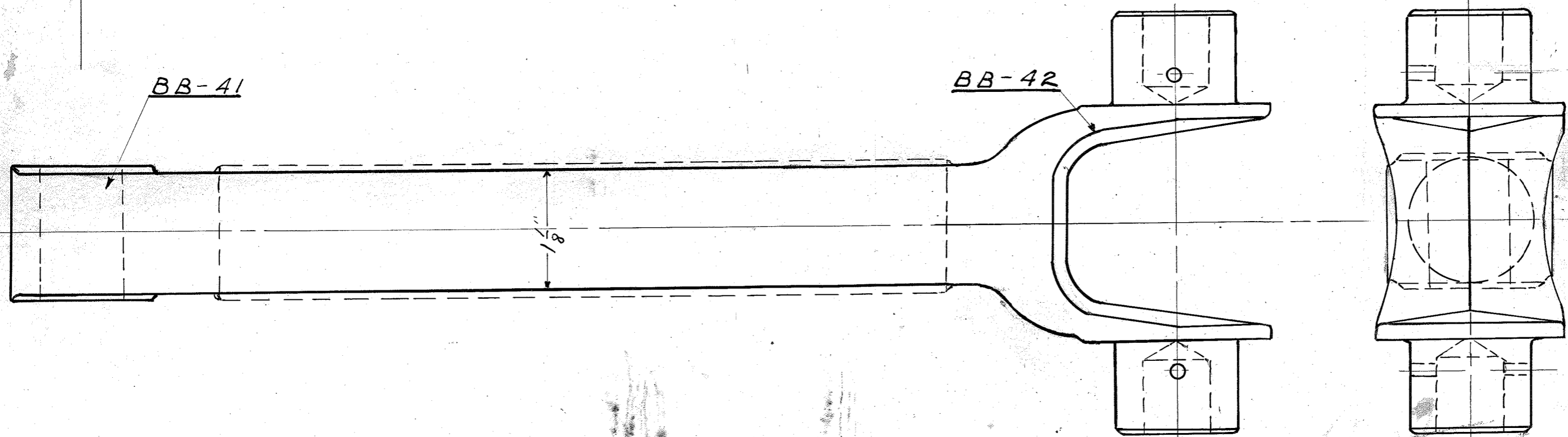

SIMPLEX FORGING STEEL.

TUDHOPE MOTOR Co
Orillia Ont.
UNIVERSAL JOINT,
SHAFT ASSEMBLY
Drawing No. B-B-43
Mat. D-F-S Simplex Forg-St.
No. required 1.
Drawn by A.W.C. Chkd. by - F.L.G.
Traced by J.L.H. App. by -
DATE 10-2-11.